

FEATURES

- Solenoid valve manufactured identically to the RCC-E 2005 compliant version
- Solenoid valve subject to standard packing, labelling, traceability and formality requirements
- Solenoid valve with IP65-rated metal cover for use in harsh industrial environments
- Rugged construction for high pressures
- The solenoid valves satisfy all relevant EC directives

GENERAL

Differential pressure

0 to 10 bar [1 bar = 100 kPa]

Storage temperature

-20°C min.

fluids (*)	temperature range (TS)	seal materials (*)
air, filtered	-10°C to +80°C	VAMAC

MATERIALS IN CONTACT WITH FLUID

(*) Ensure that the compatibility of the fluids in contact with the materials is verified

Body	Brass
Core tube	Stainless steel
Core and plugnut	Stainless steel
Internal parts	Stainless steel
Springs	Stainless steel
Seat	Brass
Seals	VAMAC

OTHER MATERIALS

Solenoid enclosure

Metal cover, black standard paint, IP65

ELECTRICAL CHARACTERISTICS

Electrical safety

IEC 335

Coil connection

Screw terminals

Coil insulation class

H

Cable entry

Connector, SAIB NU 25

Standard voltages

AC (~) : 230V / 50 Hz

operator type	power ratings			operator ambient temperature range (TS)	type ⁽¹⁾
	inrush ~	holding ~			
	(VA)	(VA)	(W)		
MB	32	20	11	-10 to +50	01

⁽¹⁾ Refer to the dimensional drawings on the following page.

SPECIFICATIONS

pipe size	orifice size	flow coefficient Kv		operating pressure differential (bar)		catalogue number	reference
				min.	max. (PS)	with impulse manual operator	
					air (*)		
					~		
Rp	(mm)	(m³/h)	(l/min)				
NC - Normally closed							
1/4	3	0.21	3.5	0	10	12102109	MB301 O3 K3 EPR

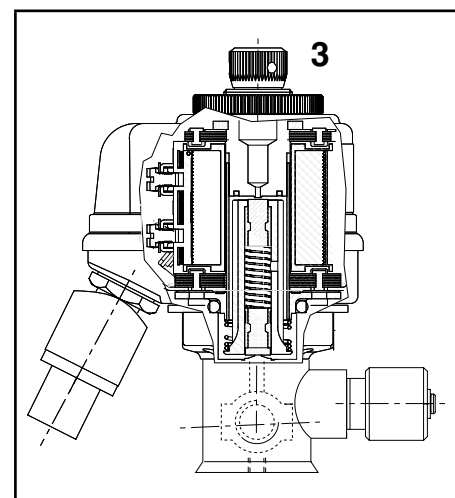

INSTALLATION

- The solenoid valve may be mounted in any position, but always with the cable outlet oriented downward. Applicable for all categories (K1, K2, K3 and NQ)
- Do not power on unless the metal cover is properly in place
- Mounting on single subbase
- Pipe connections (Rp) have standard thread according to ISO 7/1
- Replacement coils available

DIMENSIONS (mm), WEIGHT (kg)



TYPE 01

Operator type "MB"
Metal cover
IP65

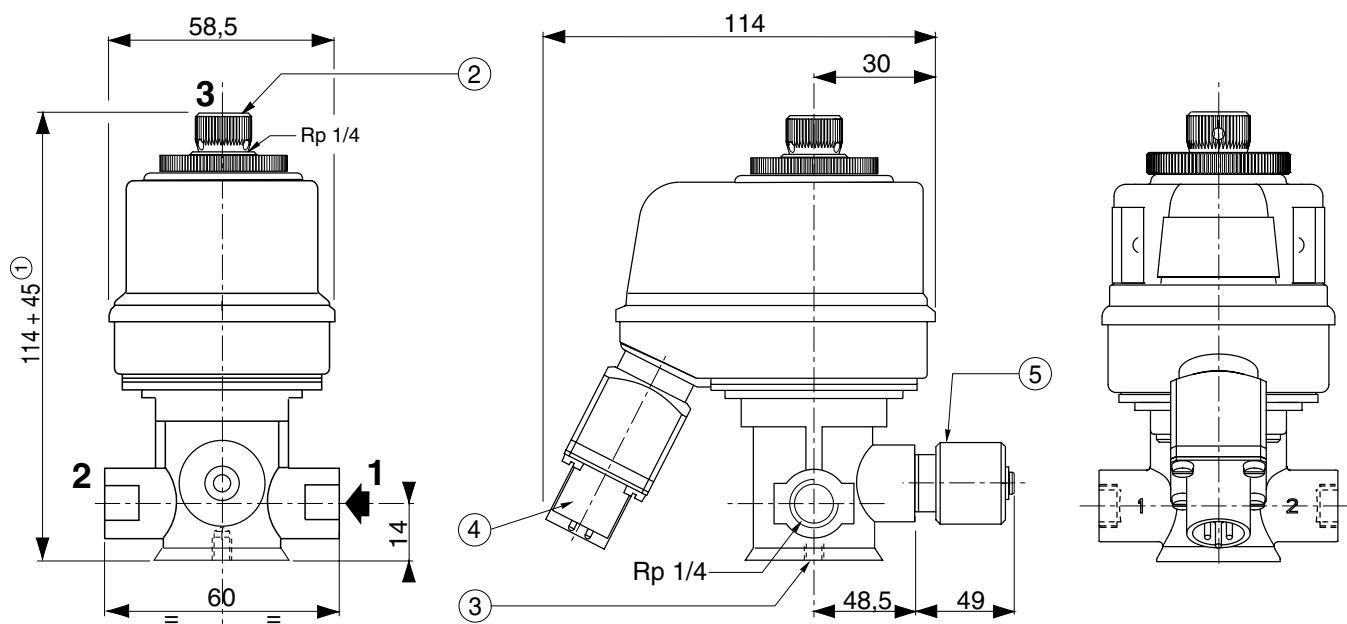

type	weight ⁽²⁾
01	1,0

⁽²⁾ including coil.

- ① Dimension to be added to allow for removal
- ② 3/2 NC: exhaust protector
- ③ Mounting hole M5, depth 7 mm
- ④ Cable entry, SAIB NU 25
- ⑤ Manual operator location

reserved.