

MINI SOLENOID VALVE

direct operated
Pad-mount body to CNOMO (15 mm width)
connector size 15

NC

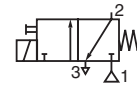

3/2
Series
302
File no.
229

FEATURES

- Low power consumption (0,5W)
- Compact, monobloc solenoid pilot valve with spade-plug connector to DIN 43650, industrial standard B, 9,4 mm spacing, or to ISO 15217/DIN 43650, form C, 8 mm spacing
- Version with integral LED and electrical protection
LED indicator visible from 3 sides
- Universal version for vacuum applications
- The solenoid valve does not comply with UL429 or EN60730 standard as burst P < 5 x nominal P

GENERAL

Differential pressure 0 to **16 bar** [1 bar = 100 kPa]
Pneumatic base ISO 15218 (CNOMO E06.36.120N, size 15)
Connection Subbase
Response times 8 - 15 ms

fluids (*)	temperature range (TS)	seal materials (*)
air or neutral gas, filtered at 50µm, lubricated or not	- 25°C to + 40°C	NBR (nitrile) FPM (fluoroelastomer)

MATERIALS IN CONTACT WITH FLUID

(*) Ensure that the compatibility of the fluids in contact with the materials is verified.

Body PAM (Polyarylamide)
Internal parts POM, PET, stainless steel and brass
Pneumatic interface seal TPE

OTHER MATERIALS

Coil Thermoplastic PET

ELECTRICAL CHARACTERISTICS

Coil insulation class F
Connector Spade plug, cable dia. 4 to 6 mm
Connector specification DIN 43650, 9,4 mm, industrial standard B or ISO 15217 / DIN 43650, 8 mm, form C
Electrical safety IEC 335
Electrical protection Moulded IP65 (EN 60529)
Standard voltage DC (=): 24V

power range	coils		nominal power ratings				ambient temperature range, solenoid operator (TS) (°C)
	voltage (V)		inrush	holding		hot/cold	
	~	=	(VA)	(VA)	(W)	(W)	
LP2	24-48-115	5-12-24-48	1,8	1,6	1,5	1,15 / 1,35	- 25°C to + 40°C

CHOICE OF EQUIPMENT

orifice size	flow				operating pressure pressure differential (bar)		power range	basic catalogue number	
	at 6 bar l/min (ANR)		coefficient Kv					impulse-type manual override	connector to ISO 15217/DIN 43650, 8 mm, form C + LED and protection
(mm)	1 → 2	2 → 3	1 → 2	2 → 3	min.	max. (PS)		=	
NC - normally closed									
0,6	11	20	0,11	0,26	0	16	LP2	30260041	

To order, please specify in addition to the basic catalogue number:

- type of current: voltage/frequency
- version type: with or without connector

	~	=
with connector	--A	--D
without connector	--L	--P

} to insert after the basic catalogue number

Examples: • with connector 24V DC : **30260041--D** 24V DC
• without connector 24V DC : **30260041--P** 24V DC

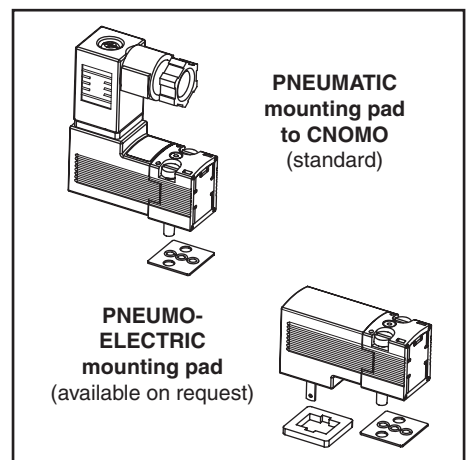

OPTIONS AND ACCESSORIES

- Valves can be supplied with FPM (fluoroelastomer) seals and diaphragms
- Version without manual operator
- Version with pneumo-electric mounting pad
- Connector to ISO 15217 / DIN 43650, 8 mm form C:
 - standard: code **881 30 211**
 - with 2 m cable: code **881 30 214**
- Connector to DIN 43650, 9,4 mm, industrial standard B:
 - standard : code **881 43 581**
 - with 2 m cable: code **881 43 567**

INSTALLATION

- The solenoid valves can be mounted in any position without affecting operation
- The solenoid valves are supplied with mounting screws and mounting pad seal(s)
- Installation/maintenance instructions are included with each solenoid valve

DIMENSIONS (mm), WEIGHT (kg)



Epoxy moulded
 IEC 335 / DIN 43650
 IP65

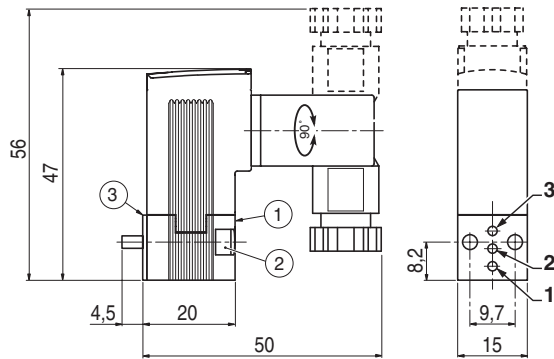

Function	Connection		
	1	2	3
NC	P	U	E

P : Pressure U : Outlet
 E : Exhaust

mounting pad pattern

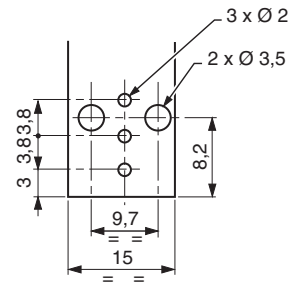

- ① Manual operator
- ② 2 mounting screws M3 x 20, with 6 lobe recess, type Torx no. 10 (supplied)
- ③ Seal (supplied)

weight (kg) (with standard connector)
0,047